

PEOPLE ENTRANCE MANAGEMENT SYSTEM

VP-PM5010SC-SGT3 SINGLE CORE SWING BARRIER GATE

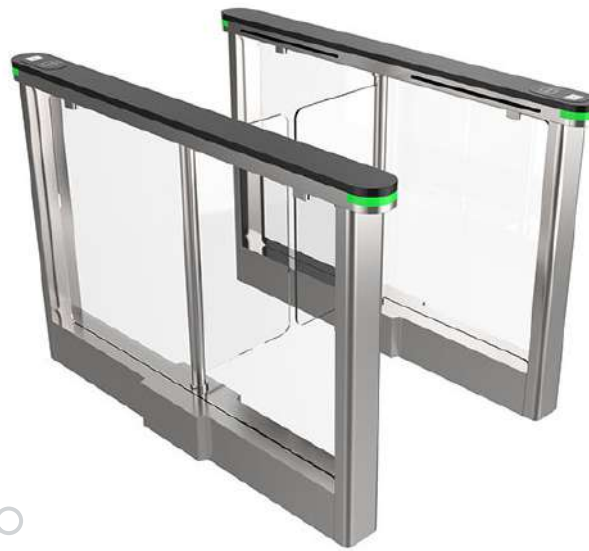

FEATURES

Selectable operating modes- single direction, bi-direction, always free or always locked

Heavy duty stainless steel Swing Barrier with Fiber glass gates

LED Direction indicators at each side

Half height operation with passage width of $\leq 600-900\text{mm}$

Throughput rate of 35 persons/minute

Double anti-clipping function, photocell anti-clipping and mechanical anti-clipping

Integration support with any RFID/Biometric Reader through NO input

Top quality AISI 304 grade SS construction with IP56 rating

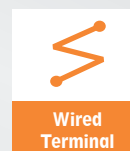
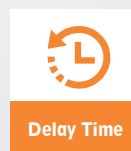
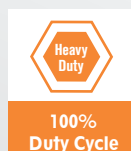

TECHNICAL SPECIFICATIONS

VP-PM5010SC-SGT3

Parameter	Specifications
Passage Width	600-900mm
Throughput Rate	35 p/m
Communication Interface	RS232 (RS485,TCP/IP)
Power Supply	100~240 V AC
Operational Voltage	24 VDC
Max Power Consumption	35W
Frequency	50~60 Hz
Protection Level	IP56
Working Temperature	-25°C~+70°C
Electro-Magnetic Drive	DC
Dimension	1500x120x980mm
Net weight	65 kg
Certifications	CE, FCC, ROHS

*Exact products and specifications shown may vary by geographic region and are subject to change without notice. Product image & weights, measurements are approximate and may vary.

DIMENSIONS

Unit: mm

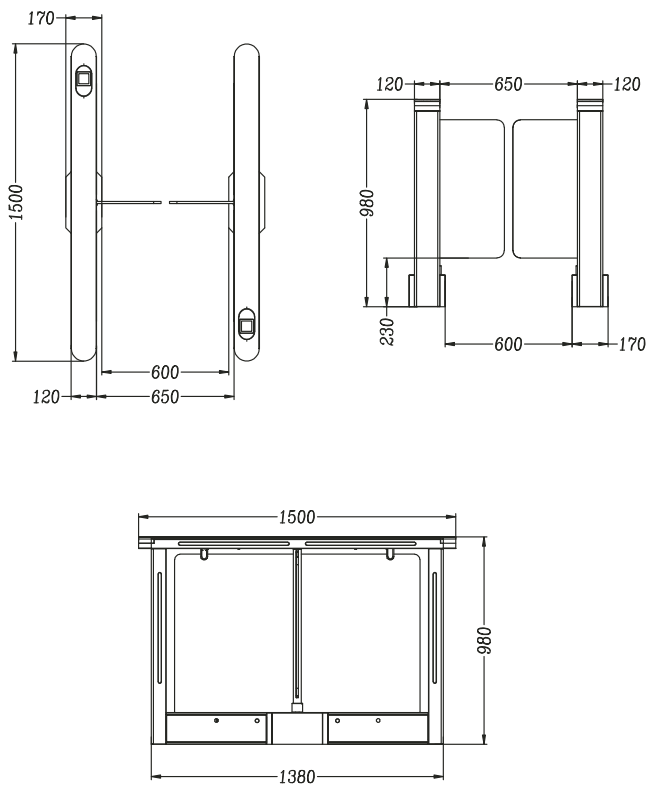

VANTAGE INTEGRATED SECURITY SOLUTIONS LIMITED.

B3, Bredon House 321, Tenttenhall Road Tettenhall, Wolverhampton

West Midlands, WV6 0JZ United Kingdom

Ph: +44-1902-793383, Email: sales@vantagesecurity.com

www.vantagesecurity.com

(AN ISO 9001 : 2008, ISO 14001:2004 CERTIFIED COMPANY)

